

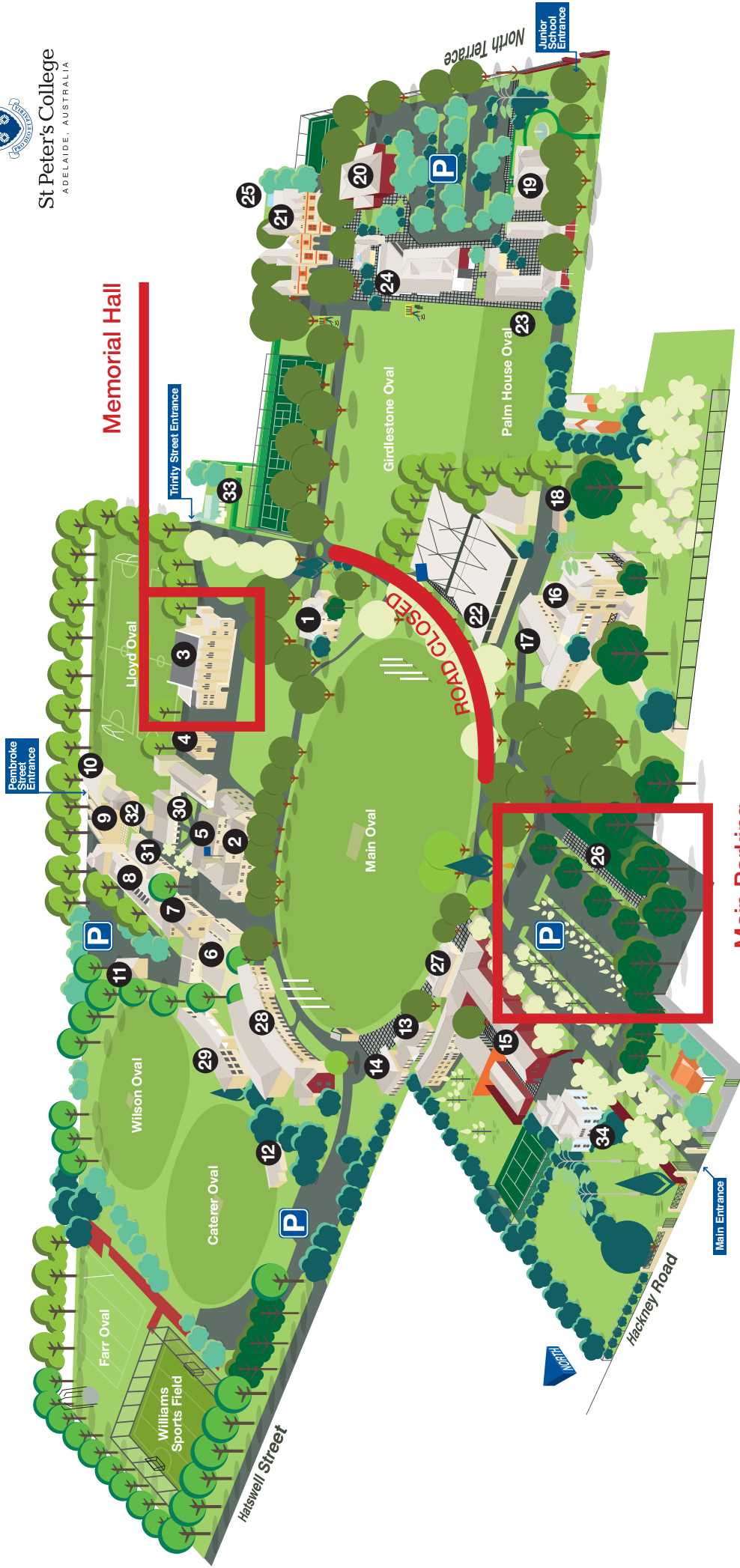

St Peter's College  
ADELAIDE, AUSTRALIA



**Memorial Hall**

**Main Parking**

- |  |                                       |  |                                       |
|--|---------------------------------------|--|---------------------------------------|
| 1. Oval House (visitors and enquiries)                                   | 9. Art and Technology                 | 18. Uniform Shop                               | 27. Nitschke Pavilion                 |
| 2. Old School House / Headmaster's Office (Senior School administration) | 10. Drama                             | 19. Old Palm House (Early Learning Centre)     | 28. Pentreath Building (Middle Years) |
| 3. Memorial Hall   | 11. Maintenance and Grounds Workshops | 20. Junior School Hall                         | 29. Gordon Building                   |
| 4. Chapel  | 12. Brookman Pavilion                 | 21. Shinkfield Building                        | 30. Big Quad                          |
| 5. Big School Room   | 13. Health Centre                     | 22. Burchinal Sports Centre                    | 31. Information Technology            |
| 6. Miller Library  | 14. Tuck Shop                         | 23. New Palm House                             | 32. Senior School Changerooms         |
| 7. Da Costa Dining Hall and Kitchen                                      | 15. Boarding House                    | 24. Bickersteth (Junior School administration) | 33. College House                     |
| 8. Florey Science  | 16. Athelney House                    | 25. Junior School Pool                         | 34. Allen House                       |
|  | 17. Hill Wing Music Centre            | 26. Goat Paddock Shed                          |                                       |

St Peter's College  
St Peters, Adelaide, Australia, 5069  
+618 8404 0400  
stpeters.sa.edu.au  
@SPC\_Adelaide